

6. Exceptional Casing Shoe Designs

Symmetrix 135 STD
Please note the 2 options of
135 STD casing shoe

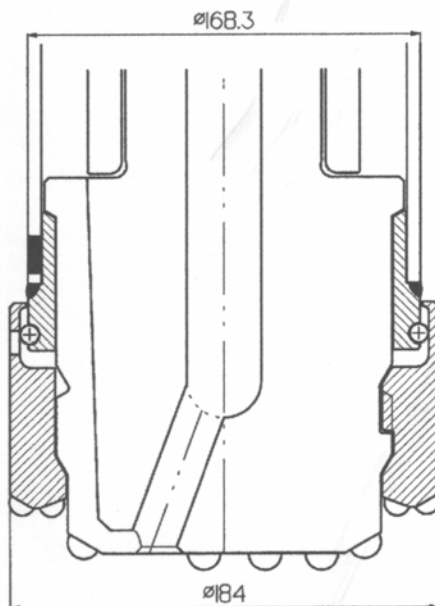

Conventional casing shoe

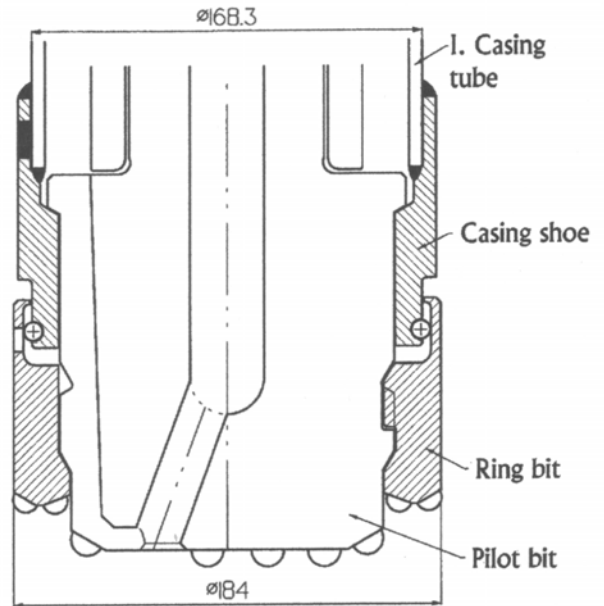

Casing shoe design to adopt all casing wall thicknesses

Symmetrix 155 STD
Please note the design of
155 STD casing shoe

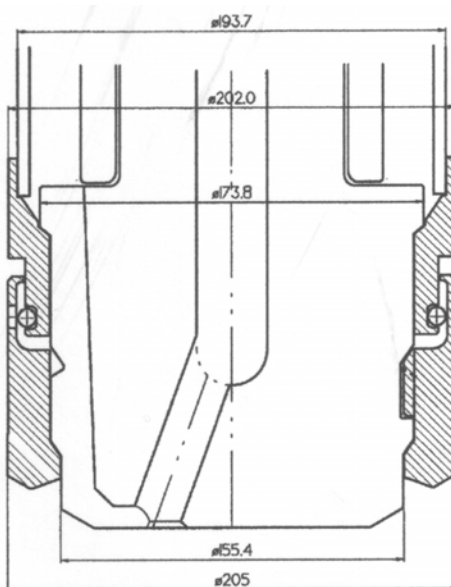

Casing shoe design to adopt any casing wall thickness

Symmetrix 165 STD
Please note the design of
165 STD casing shoe

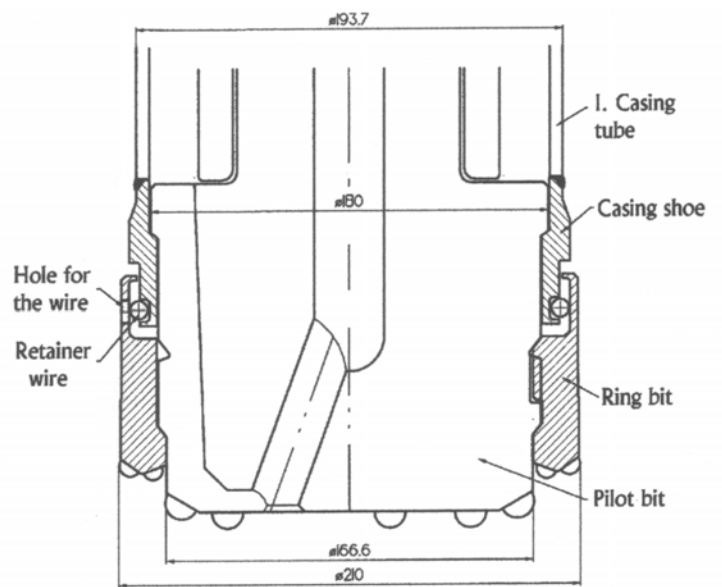

Casing shoe design allows maximal drill through diameter



Symmetrix for drilling 7" casing with 6" DTH-hammer

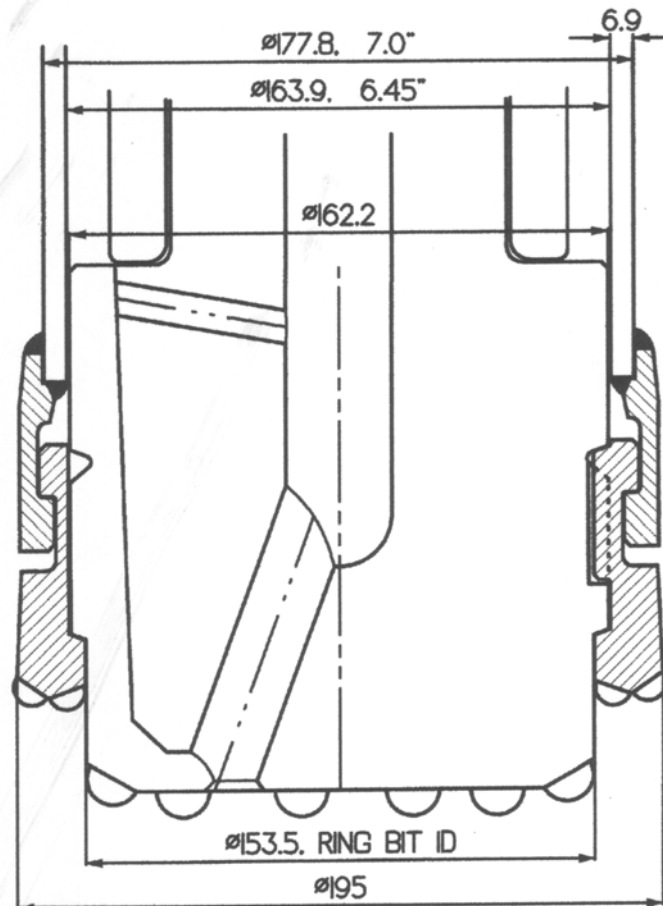

Symmetrix W153 for 6" hammer

- In some places it is a common practice in water well-drilling to use 7" (177.8) casing with 6" hammer and to continue with standard 6" bit into bedrock
- Symmetrix W153 meets these requirements

